

Proloquo2Go

Getting Started

Version 1.7



Proloquo2Go was designed to be easy to use and customize

Table of Contents

Basic use and views	3
Item Size	13
Easy Editing	15
Copy and Paste	25
Auto-Morphology	29
Options	32

© 2009-2011 AssistiveWare B.V.. All Rights reserved.

Press buttons to speak messages and navigate to categories.



Press the message window to speak a message.



Delete letters or words...double tap to clear.



Three Views

Grid or List Recents Typing

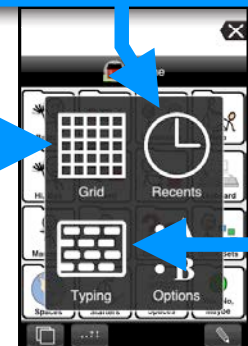

Grid View

Change in Options

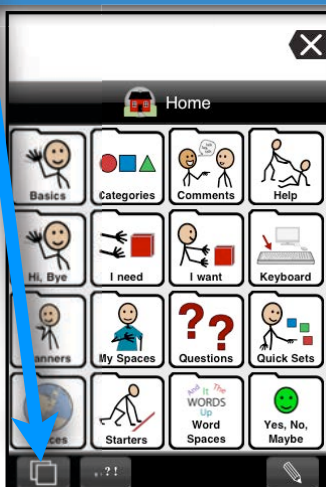

List View

Change in Options

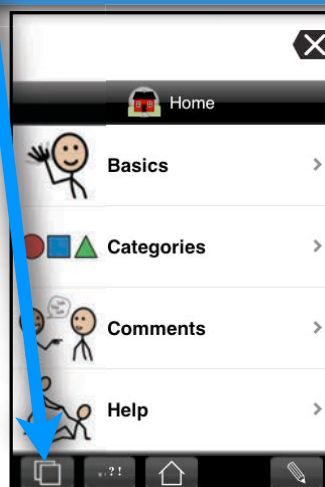

Recents View

Overview

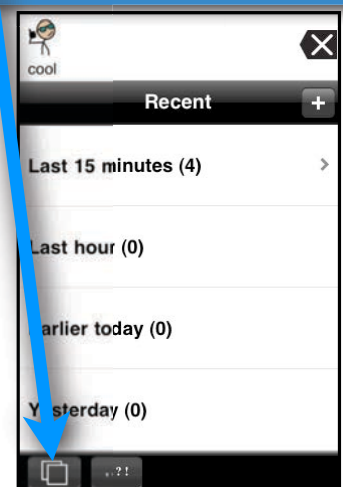

Recents View

Detail

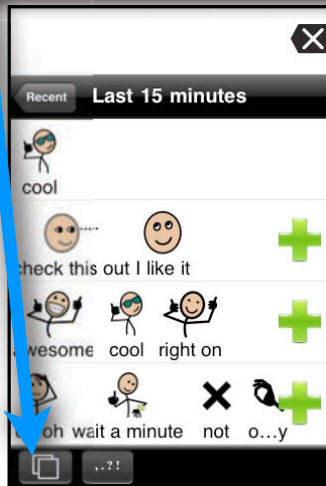

10

Typing View

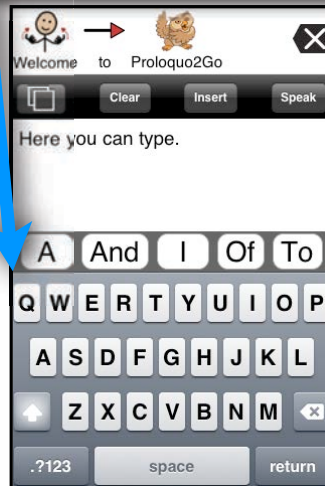

11

Punctuation

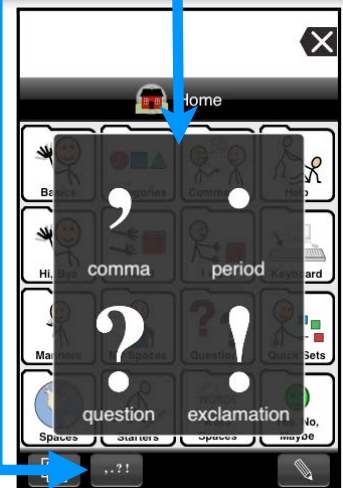

12

Item Size: Change in Options

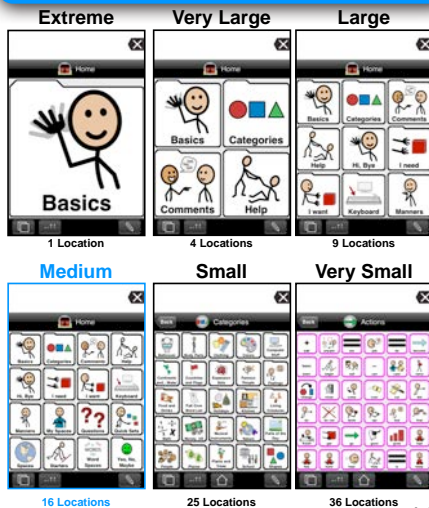

13

Wide Item Size: Change in Options

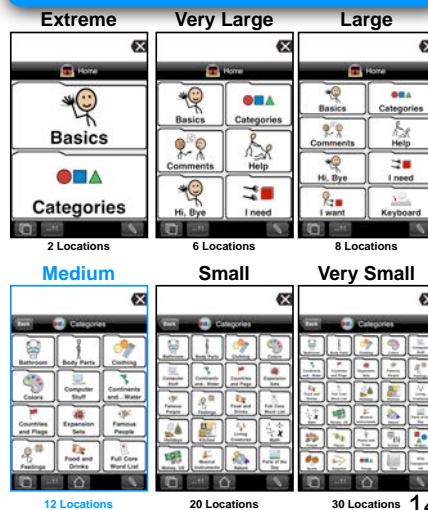

14

Easy Editing



15

Add items from the message window.



16

Add items from Recents.



17

Add items in Edit Mode.

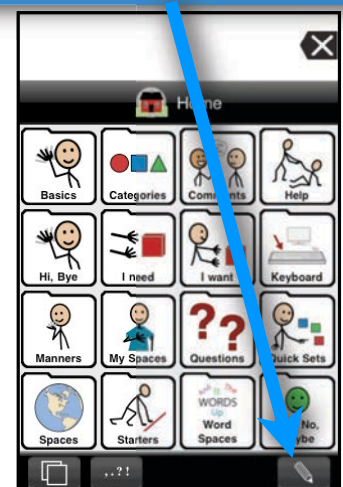

18

Customize the new item.



19

Select an image to use:

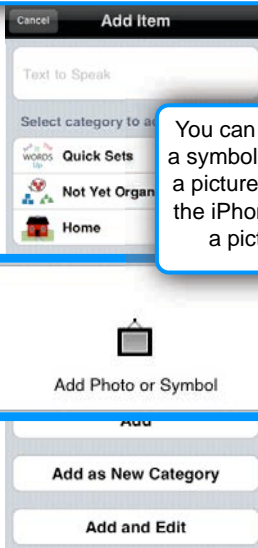

20

You can choose to add a symbol to an item.



21

You can choose to add an image from your image library to an item.

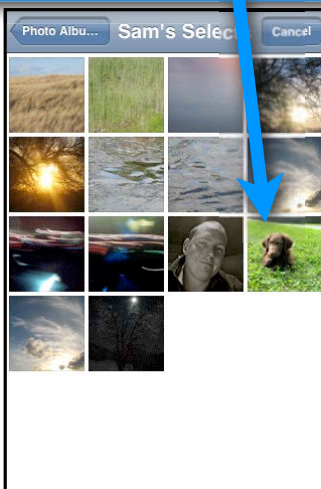

22

With the most recent devices, you can choose to take a picture and add it to an item.

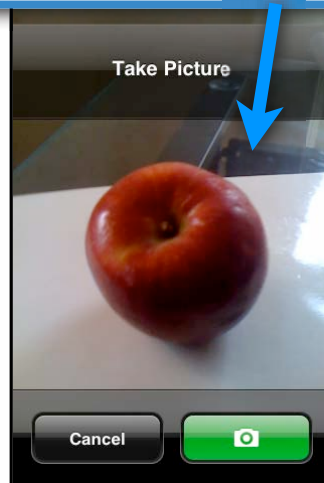

23

TIP You can add as a new category. This makes creating new sets easy!



24

Copy and Paste your way to quickly creating new sets.

Let's say you wanted to quickly create this Grocery Shopping Category.



25

Press Edit, touch the item you want, and select copy...



26

...copy more items if you like..

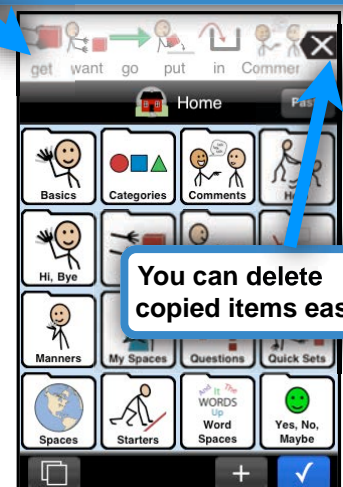

27

...and paste where you like.

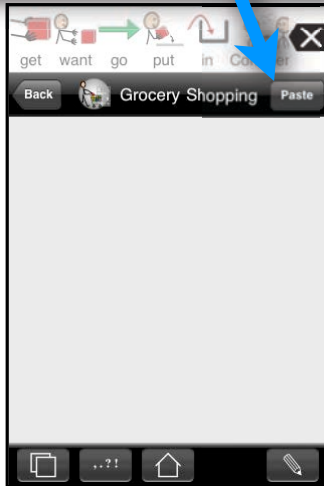

28

Auto-Morphology

Auto-Conjugate
Auto-Plural
Auto-Possessive



29

Auto-Conjugation can help you transform verbs quickly and powerfully. Press and hold is the default trigger.

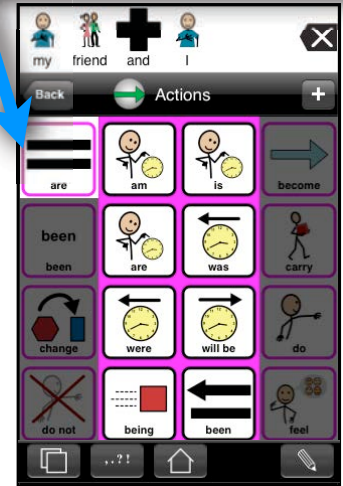

30

Auto-Plural and Auto-Possessives make working with nouns easy. Press and hold is the default trigger.



31

Options

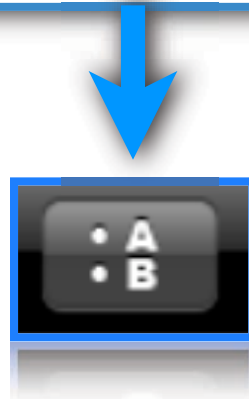

32

If you don't see the Options button, go to your device's Settings.



33

In **Settings**, scroll down to Proloquo2Go.



34

Set the "Show options button" switch to ON.

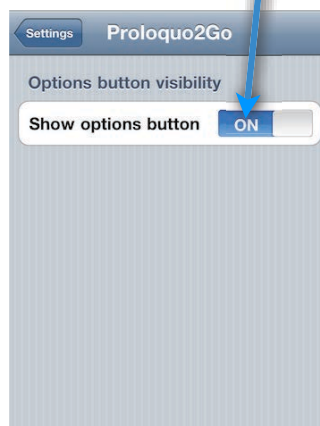

35

Choose an option:

Speech, Backup, Appearance, Interaction, Grammar, Prediction, Vocabulary, Privacy, Restrictions, Demo Mode, Statistics, About, Support, or Password.

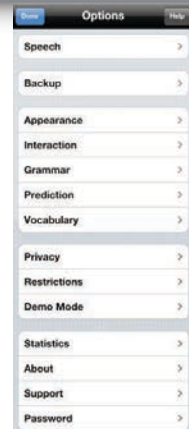

36

Speech Options

- Change voice
- Manage and download voices
- Change volume
- Change speech rate
- Change pronunciations
- Change voice characteristics

37

"Speak Message Only" makes Proloquo2Go only speak when the message window is pressed.

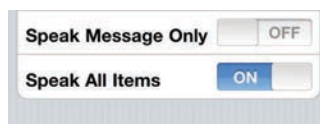

"Speak All Items" toggles between speaking everything as it is constructed or only speaking items that go to the message window, not navigation items.

38

Voice Manager

- Delete voices (default voices cannot be deleted)
- Default voices
- Downloaded voices

39

Voice Download Manager

- Choose voices to download
- Pause all voice downloads, or resume downloading if paused
- Cancel downloading this voice

40

- Search by voice name or language
- Country
- Listen to the voice preview
- Download this voice

41

Backup Options

- Create a backup
- Back up and restore with your computer
- Restore on device
- Enable Reset to Factory Defaults in Settings, Restrictions

42

Appearance

- Display
- Grid
- Color
- Text
- Images

43

Display

- Toggle the message window on or off
- Change the message window size
- Change the item size: Very small to extreme
- Change the toolbar size

44

Grid

- Switch between Grid and List View.
- Change to wider grid items.
- Change the amount of empty space between items.

45

Color

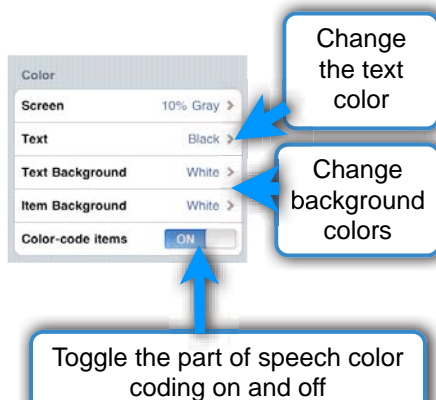

46

The color coding scheme after (Goossens, Crain, Elder, 1992)

Words	Colors
Verbs	pink
Descriptors (Adjectives and Adverbs)	blue
Prepositions (such as In, Off)	green
Nouns	yellow
Miscellaneous (Interjections, Pronouns, Articles, and Conjunctions)	orange

47

Text

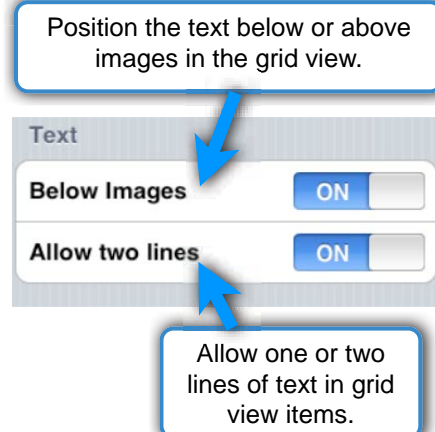

48

Images

Options to have images displayed, or alternatively, just words.

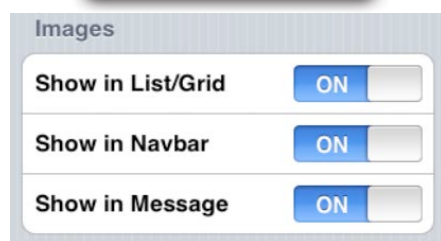

49

Interaction

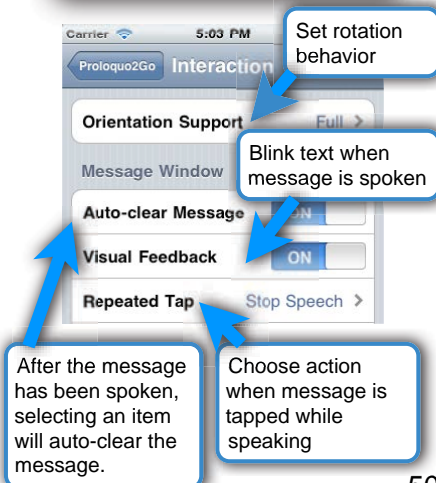

50

Interaction

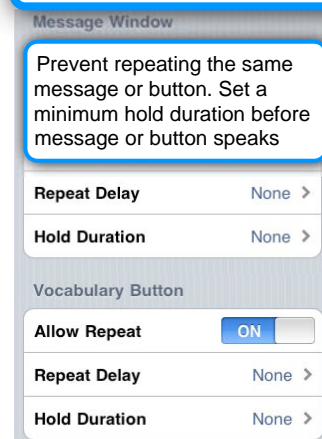

51

Interaction

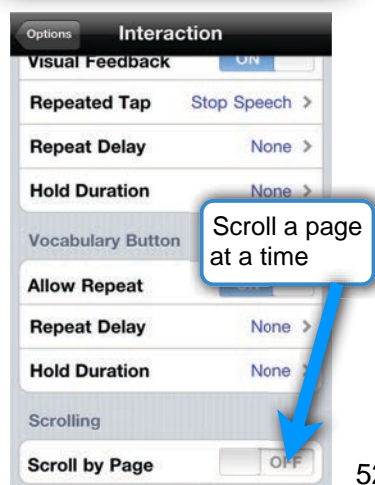

52

Grammar: Activate and control the Auto-Morphology Features.

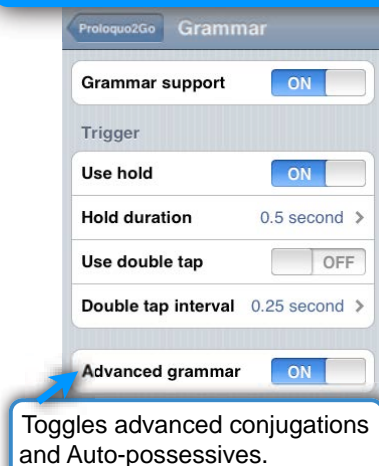

53

Prediction: Turn prediction on/off and configure it to your liking

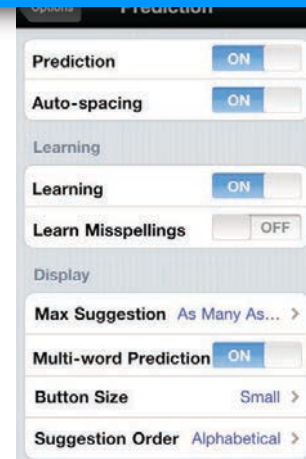

54

Vocabulary Options

Change the home screen to best meet your needs.

Temporarily switch back to root for editing

Change vocabulary size, using the importance feature

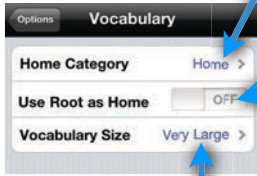

55

Set **Restrictions** to control access to functions and views.



56

Demo Mode Activation

If you turn Demo mode on, Proloquo2Go will reset to its default state every time you quit it or every day at midnight. Downloaded materials and any changes to application settings or content will be lost.

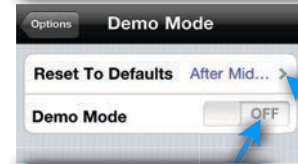

Turn Demo mode on or off

Specify when to reset

57

Statistics, Support, and Password

Get statistics on the vocabulary

Get help or learn more about Proloquo2Go

Visit the Proloquo2Go website or email for support

Enable password protection or change password

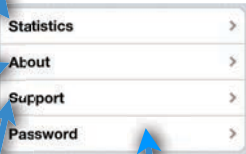

58

Password Options

Enable protection with password

Change password

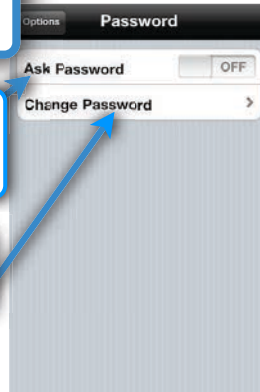

59